

# MPS Monitor™ Install

## Hardware Installation:

1. Plug Ethernet from Wall/Router into “N” port on the ARData tool.
2. Plug Ethernet from “P” port on tool into the device. (Optional)
3. Plug USB Power into the ARData tool and power source (USB or Wall)
4. Installation is complete when there are activity lights on Ethernet ports and red blinking power indicator on the ARData tool.

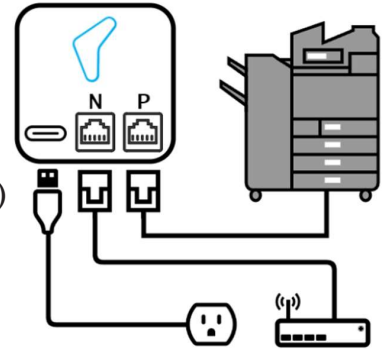

## Acquire Registration Information:

1. Log in to the MPS Monitor Portal
2. Navigate to the customer you would like to register the ARData tool with
3. Click on **Download Connectors**
4. Take note of the **Customer Code**
5. Take note of an available **License Code**  
(Click **Generate License** if none are available)

Connectors for other operating systems and printers

Customer Code: **ABCDEF1234**

Available licenses

License code: **aaaaaaaa-bbbb-cccc-dddd-eeeeeeeeeeee**

## Register the ARData Tool:

1. Connect the provided USB-LCD Screen to the USB port on the side of the device to display it's IP Address.
2. From a computer on the same network, enter the IP Address of the ARData tool in a web browser
3. Enter/Paste the **Customer Code** and **License Code**, set the correct time zone, then click **Submit**. The ARData tool will reboot.
4. Registration is now complete, and you will be redirected automatically to the MPS Monitor Status Page on port 8888. Verify that registration was successful and close the window.

*Note that once the tool is registered, the web page is disabled. Disconnect, then reconnect the USB-LCD screen to re-enable the web services.*

**mpsMonitor**  
Printer Monitoring in the Cloud

Customer Code: **ABCDEF1234**

License Code: **aaaaaaaa-bbbb-cccc-dddd-eeeeeeeeeeee**

Select Your Time Zone  
(GMT -5:00) Eastern Time (US & Canada), Bogota, Lima

**Submit**

## Enable SNMP for Discovery:

1. In the MPS Monitor Portal, navigate to **[Customer] > Connectors > Configurations**
2. Select the DEFAULT (or custom) configuration to edit
3. Click Show Advanced Parameters and enable **Use only SNMP for discovery**, then click **Save** to apply.

Description: DEFAULT

Enabled: ☒

Connector System Name: MPSMonitor-2404 [aaaaaaaa-bbbb-cccc-dddd-eeeeeeeeeeee]

Hide advanced parameters

Advanced parameters

Number of scanning parallel processes: 10

**Use only SNMP for discovery** ☒

Activate file exclusion mode: ☒

All third party trademarks (including logos and icons) referenced by ARData remain the property of their respective owners (MPS Monitor s.r.l.) and use of trademarks does not mean endorsement.